

The opening hours of the premises:

Sunday to Thursday 1200 to 2300

Friday to Saturday 1200 to 0030

Supply of alcohol for consumption ON the premises, ancillary to a meal.

- 1.3 If granted the variation will see an increase in the availability of alcohol at the premises by 11 hours Sunday to Thursday. Friday and Saturday the increase is 9hrs 30minutes.

The premises would also be able to offer live and recorded music and the performance of dance for up to 22 hours per day Monday to Sunday. There is no provision for regulated entertainment on the current licence.

The addition of Late Night Refreshment is also requested for 4hrs 30minutes per day. The LSC should note that the current conditions on the licence requires that the alcohol is only served with food but the current licence does not carry the provision of late night refreshment, so gives the impression that some alcohol sales are carried out outside of the conditions and sales are made without the provision of food.

- 1.4 The hours and additional licensable activity will see a significant change in the mode of operation of the premises. The premises is set along a terrace of shops with residential properties directly above and additional residential accommodation being built nearby.

2 Recommendations

There is no recommendation, but in considering the representations received and what is appropriate for the promotion of the licensing objectives, the steps the Sub-Committee can take are:

- Grant the variation as requested
- Grant the variation whilst imposing additional conditions and/or altering in any way the proposed operating schedule.
- Exclude any licensable activities to which the application relates
- Reject the whole or part of the application

- 2.1 Members of the licensing sub committee are asked to note that they may not modify the conditions or reject the whole or part of the application merely because it considers it desirable to do so. It must be appropriate in order to promote the licensing objectives.

3. Background

- 3.1 The premise was initially granted a licence for alcohol sales only with meals in August 2014. Medina Basirika took over the licence in June 2015
The premises has a history of non compliance in the past and first came to attention of officers through complaints received from residents in 2014 relating to noise in the early hours of the morning from the venue. The premises also has Planning permission that only permits it to open until 23.00pm, this was to ensure that residents were not adversely affected by the operation of the venue when it was granted permission to operate as a take away/restaurant in 2013.
- 3.2 During the consultation period letters of representation were received from residents who have previously been affected by the operation of the premises.
Representation was also received from the Metropolitan Police and the Licensing Authority against any increase of the hours or the ability to now add regulated entertainment to the licence. There is potential for the additional hours to give rise to noise nuisance to nearby residents.
- 3.3 Under the Act representations can be received from responsible authorities or other persons. Representations must be relevant and, in the case of another person, must not be frivolous or vexatious.
- 3.4 The Licensing Authority considers that restrictions may be made to the proposed hours of use where, after receiving relevant representations, the council considers it appropriate for the promotion of the licensing objectives to do so. The council will take into account the existing pattern of licenced premises in an area when considering what is appropriate to promote the objectives.
Applications which are significantly out of character for a locality will need to demonstrate that granting the hours sought will not impact on the licensing objectives, given the potential for neighbouring premises to be adversely impacted.

4. Policy Implications

- 4.1 The decision should be made with regard to the Secretary of the State's guidance and the Council's Statement of Licensing Policy under the Licensing Act 2003. Where the decision departs from either the Guidance or the Policy clear and cogent reasons must be given. Members should be aware that if such a departure is made the risk of appeal / challenge is increased.

4.2 Equalities impact

At the time of writing this report there were no implications for equality and diversity. Any decision taken by the Licensing Sub-Committee will be in accordance with the four licensing objectives as prescribed by the Licensing Act 2003.

5. Other considerations

5.1 Human Rights

While all Convention Rights must be considered, those which are of particular relevance to the application are:

- Article 8 – Right to respect for private and family life.
- Article 1 of the First Protocol – Protection of Property
- Article 6(1) – Right to a fair hearing.
- Article 10 – Freedom of Expression

6 Use of Appendices

Appendix 1- Variation application form

Appendix 1A- copy of current licence

Appendix 2 – Letter of representation from Licensing Authority

Appendix 3- Letter of representation from Met Police.

Appendix 4- Letters of representation from residents.

Background papers: Section 82 Guidance
Haringey Statement of Licensing policy

Appendix 1- Variation application form



Application to vary a premises licence under the Licensing Act 2003

HARINGEY COUNCIL
LICENSING
RECEIVED
- 9 NOV 2015

Reference number:

WK/338004

(1)

PLEASE READ THE FOLLOWING INSTRUCTIONS FIRST

Before completing this form please read the guidance notes at the end of the form.
If you are completing this form by hand please write legibly in block capitals. In all cases ensure that your answers are inside the boxes and written in black ink. Use additional sheets if necessary. You may wish to keep a copy of the completed form for your records

(2) I/We **MEDIWA BASIRIKA**

being the premises licence holder, apply to vary a premises licence under section 34 of the Licensing Act 2003 for the premises described in Part 1 below

Premises licence number

LN/000013122

Part 1 - Premises details

Postal address of premises or, if none, Ordnance Survey map reference or description
118 WEST GREEN ROAD
TOTTENHAM

Post town **TOTTENHAM** Postcode **N15 5AA**

Telephone number at premises (if any) **02087301814**

Non-domestic rateable value of premises **£**

Part 2 - Applicant details

Daytime contact telephone number **0741271815**

E-mail address (optional) **MDXAN81@GMAIL.COM**

Current postal address if different from premises address
118 WEST GREEN ROAD

Post town **TOTTENHAM** Postcode **N15 5AA**

(1) Insert name and address of relevant licensing authority and its reference number (optional)
(2) Insert name(s) of applicant

Part 3 - Variation

Please tick yes

Do you want the proposed variation to have effect as soon as possible?

If not do you want the variation to take effect from

Day	Month	Year

Please describe briefly the nature of the proposed variation (Please read guidance note 1)

What consideration have you given to the immediate locality with regards to the licensable activities you are applying for?

If your proposed variation would mean that 5,000 or more people are expected to attend the premises at any one time, please state the number expected to attend

Part 4 - Operating Schedule

Please complete those parts of the Operating Schedule below which would be subject to change if this application to vary is successful.

Provision of regulated entertainment

Please tick yes

- a) plays (if ticking yes, fill in box A)
- b) films (if ticking yes, fill in box B)
- c) indoor sporting events (if ticking yes, fill in box C)
- d) boxing or wrestling entertainment (if ticking yes, fill in box D)
- e) live music (if ticking yes, fill in box E)
- f) recorded music (if ticking yes, fill in box F)
- g) performances of dance (if ticking yes, fill in box G)
- h) anything of a similar description to that falling within (e), (f) or (g) (if ticking yes, fill in box H)

Provision of entertainment facilities for:

- i) making music (if ticking yes, fill in box I)
- j) dancing (if ticking yes, fill in box J)
- k) entertainment of a similar description to that falling within (i) or (j) (if ticking yes, fill in box K)

Provision of late night refreshment (if ticking yes, fill in box L)

Sale by retail of alcohol (if ticking yes, fill in box M)

In all cases complete boxes N, O and P

A

Plays			Will the performance of a play take place indoors or outdoors or both - please tick <input checked="" type="checkbox"/> (please read guidance note 2)
Day	Start	Finish	
Standard days and timings (please read guidance note 6)			Indoors <input type="checkbox"/> Outdoors <input type="checkbox"/> Both <input type="checkbox"/>
Mon			Please give further details here (please read guidance note 3)
Tue			
Wed			State any seasonal variations for performing plays (please read guidance note 4)
Thur			
Fri			Non-standard timings. Where you intend to use the premises for the performance of plays at different times from those listed in the column on the left, please list (please read guidance note 5)
Sat			
Sun			

B

Films			Will the exhibition of films take place indoors or outdoors or both - please tick <input checked="" type="checkbox"/> (please read guidance note 2)
Day	Start	Finish	
Standard days and timings (please read guidance note 6)			Indoors <input type="checkbox"/> Outdoors <input type="checkbox"/> Both <input type="checkbox"/>
Mon			Please give further details here (please read guidance note 3)
Tue			
Wed			State any seasonal variations for the exhibition of films (please read guidance note 4)
Thur			
Fri			Non-standard timings. Where you intend to use the premises for the exhibition of films at different times from those listed in the column on the left, please list (please read guidance note 5)
Sat			
Sun			

C

Indoor sporting events			Please give further details here (please read guidance note 3)
Day	Start	Finish	
Mon			
Tue			State any seasonal variations for indoor sporting events (please read guidance note 4)
Wed			
Thur			Non-standard timings. Where you intend to use the premises for indoor sporting events at different times from those listed in the column on the left, please list (please read guidance note 5)
Fri			
Sat			
Sun			

D

Boxing or wrestling entertainments			Will the boxing or wrestling entertainment take place indoors or outdoors or both - please tick <input checked="" type="checkbox"/> (please read guidance note 2)
Day	Start	Finish	
Mon			Indoors <input type="checkbox"/> Outdoors <input type="checkbox"/> Both <input type="checkbox"/>
			Please give further details here (please read guidance note 3)
Tue			
			State any seasonal variations for boxing or wrestling entertainment (please read guidance note 4)
Wed			
Thur			
			Non-standard timings. Where you intend to use the premises for boxing or wrestling entertainment at different times from those listed in the column on the left, please list (please read guidance note 5)
Fri			
Sat			
Sun			

E

Live music			Will the performance of live music take place indoors or outdoors or both - please tick <input checked="" type="checkbox"/> (please read guidance note 2)
Standard days and timings (please read guidance note 6)			
Day	Start	Finish	Indoors <input checked="" type="checkbox"/> Outdoors <input type="checkbox"/> Both <input type="checkbox"/>
Mon	6.00 AM	4.00 AM	Please give further details here (please read guidance note 3)
Tue	6.00 AM	4.00 AM	
Wed	6.00 AM	4.00 AM	State any seasonal variations for the performance of live music (please read guidance note 4)
Thur	6.00 AM	4.00 AM	
Fri	6.00 AM	4.00 AM	Non-standard timings. Where you intend to use the premises for the performance of live music at different times from those listed in the column on the left, please list (please read guidance note 5)
Sat	6.00 AM	4.00 AM	
Sun	6.00 AM	4.00 AM	

F

Recorded music			Will the playing of recorded music take place indoors or outdoors or both - please tick <input checked="" type="checkbox"/> (please read guidance note 2)
Standard days and timings (please read guidance note 6)			
Day	Start	Finish	Indoors <input checked="" type="checkbox"/> Outdoors <input type="checkbox"/> Both <input type="checkbox"/>
Mon	6.00 AM	4.00 AM	Please give further details here (please read guidance note 3)
Tue	6.00 AM	4.00 AM	
Wed	6.00 AM	4.00 AM	State any seasonal variations for the playing of recorded music (please read guidance note 4)
Thur	6.00 AM	4.00 AM	
Fri	6.00 AM	4.00 AM	Non-standard timings. Where you intend to use the premises for the playing of recorded music at different times from those listed in the column on the left, please list (please read guidance note 5)
Sat	6.00 AM	4.00 AM	
Sun	6.00 AM	4.00 AM	

G

Performances of dance			Will the performance of dance take place indoors or outdoors or both - please tick <input checked="" type="checkbox"/> (please read guidance note 2)
Day	Start	Finish	
Standard days and timings (please read guidance note 6)			Indoors <input checked="" type="checkbox"/> Outdoors <input type="checkbox"/> Both <input type="checkbox"/>
Mon	6.00 AM	4.00 PM	Please give further details here (please read guidance note 3)
Tue	6.00 AM	4.00 PM	
Wed	6.00 AM	4.00 PM	State any seasonal variations for the performance of dance (please read guidance note 4)
Thur	6.00 AM	4.00 PM	
Fri	6.00 AM	4.00 PM	Non-standard timings. Where you intend to use the premises for the performance of dance at different times from those listed in the column on the left, please list (please read guidance note 5)
Sat	6.00 AM	4.00 PM	
Sun	6.00 AM	4.00 PM	

H

Anything of a similar description to that falling within (e), (f) or (g)			Please give a description of the type of entertainment you will be providing
Day	Start	Finish	
Standard days and timings (please read guidance note 6)			PROVISION OF LIVE MUSIC & RECORDED MUSIC AS WELL AS PERFORMANCES OF PERFORMANCES OF DANCE TOO
Day	Start	Finish	
Mon	6.00 AM	4.00 PM	Will this entertainment take place indoors or outdoors or both - please tick <input checked="" type="checkbox"/> (please read guidance note 2)
			Indoors <input checked="" type="checkbox"/> Outdoors <input type="checkbox"/> Both <input type="checkbox"/>
Tue	6.00 AM	4.00 PM	Please give further details here (please read guidance note 3)
Wed	6.00 AM	4.00 PM	
Thur	6.00 AM	4.00 PM	State any seasonal variations for entertainment of a similar description to that falling within (e), (f) or (g) (please read guidance note 4)
Fri	6.00 AM	4.00 PM	
Sat	6.00 AM	4.00 PM	Non-standard timings. Where you intend to use the premises for entertainment of a similar description to that falling within (e), (f) or (g) at different times from those listed in the column on the left, please list (please read guidance note 5)
Sun	6.00 AM	4.00 PM	

Provision of facilities for making music			Please give a description of the facilities for making music you will be providing																								
Standard days and timings (please read guidance note 6)																											
<table border="1"> <thead> <tr> <th>Day</th> <th>Start</th> <th>Finish</th> </tr> </thead> <tbody> <tr> <td>Mon</td> <td>6.00 AM</td> <td>4.00 PM</td> </tr> <tr> <td>Tue</td> <td>6.00 AM</td> <td>4.00 PM</td> </tr> <tr> <td>Wed</td> <td>6.00 AM</td> <td>4.00 PM</td> </tr> <tr> <td>Thur</td> <td>6.00 AM</td> <td>4.00 PM</td> </tr> <tr> <td>Fri</td> <td>6.00 AM</td> <td>4.00 PM</td> </tr> <tr> <td>Sat</td> <td>6.00 AM</td> <td>4.00 PM</td> </tr> <tr> <td>Sun</td> <td>6.00 AM</td> <td>4.00 PM</td> </tr> </tbody> </table>			Day	Start	Finish	Mon	6.00 AM	4.00 PM	Tue	6.00 AM	4.00 PM	Wed	6.00 AM	4.00 PM	Thur	6.00 AM	4.00 PM	Fri	6.00 AM	4.00 PM	Sat	6.00 AM	4.00 PM	Sun	6.00 AM	4.00 PM	Will the facilities for making music be indoors or outdoors or both - please tick <input checked="" type="checkbox"/> (please read guidance note 2) Indoors <input checked="" type="checkbox"/> Outdoors <input type="checkbox"/> Both <input type="checkbox"/>
Day	Start	Finish																									
Mon	6.00 AM	4.00 PM																									
Tue	6.00 AM	4.00 PM																									
Wed	6.00 AM	4.00 PM																									
Thur	6.00 AM	4.00 PM																									
Fri	6.00 AM	4.00 PM																									
Sat	6.00 AM	4.00 PM																									
Sun	6.00 AM	4.00 PM																									
			Please give further details here (please read guidance note 3)																								
			State any seasonal variations for the provision of facilities for making music (please read guidance note 4)																								
			Non-standard timings. Where you intend to use the premises for provision of facilities for making music entertainment at different times from those listed in the column on the left, please list (please read guidance note 5)																								

J

Provision of facilities for dancing			Please give a description of the facilities for dancing you will be providing																								
Standard days and timings (please read guidance note 6)																											
<table border="1"> <thead> <tr> <th>Day</th> <th>Start</th> <th>Finish</th> </tr> </thead> <tbody> <tr> <td>Mon</td> <td>6.00 AM</td> <td>4.00 AM</td> </tr> <tr> <td>Tue</td> <td>6.00 AM</td> <td>4.00 AM</td> </tr> <tr> <td>Wed</td> <td>6.00 AM</td> <td>4.00 AM</td> </tr> <tr> <td>Thur</td> <td>6.00 AM</td> <td>4.00 AM</td> </tr> <tr> <td>Fri</td> <td>6.00 AM</td> <td>4.00 AM</td> </tr> <tr> <td>Sat</td> <td>6.00 AM</td> <td>4.00 AM</td> </tr> <tr> <td>Sun</td> <td>6.00 AM</td> <td>4.00 AM</td> </tr> </tbody> </table>			Day	Start	Finish	Mon	6.00 AM	4.00 AM	Tue	6.00 AM	4.00 AM	Wed	6.00 AM	4.00 AM	Thur	6.00 AM	4.00 AM	Fri	6.00 AM	4.00 AM	Sat	6.00 AM	4.00 AM	Sun	6.00 AM	4.00 AM	Will the facilities for dancing be indoors or outdoors or both - please tick <input checked="" type="checkbox"/> (please read guidance note 2) Indoors <input checked="" type="checkbox"/> Outdoors <input type="checkbox"/> Both <input type="checkbox"/>
Day	Start	Finish																									
Mon	6.00 AM	4.00 AM																									
Tue	6.00 AM	4.00 AM																									
Wed	6.00 AM	4.00 AM																									
Thur	6.00 AM	4.00 AM																									
Fri	6.00 AM	4.00 AM																									
Sat	6.00 AM	4.00 AM																									
Sun	6.00 AM	4.00 AM																									
			Please give further details here (please read guidance note 3)																								
			State any seasonal variations for providing dancing facilities (please read guidance note 4)																								
			Non-standard timings. Where you intend to use the premises for the provision of facilities for dancing at different times from those listed in the column on the left, please list (please read guidance note 5)																								

K

Provision of facilities for entertainment of a similar description to that falling within I or J			Please give a description of the type of entertainment facility you will be providing
Standard days and timings (please read guidance note 6)			Will the entertainment facility be indoors or outdoors or both - please tick <input checked="" type="checkbox"/> (please read guidance note 2)
Day	Start	Finish	Indoors <input checked="" type="checkbox"/> Outdoors <input type="checkbox"/> Both <input type="checkbox"/>
Mon	6.00AM	4.00PM	Please give further details here (please read guidance note 3)
Tue	6.00AM	4.00PM	
Wed	6.00AM	4.00PM	State any seasonal variations for the provision of the facilities for entertainment of a similar description to that falling within I or J (please read guidance note 4)
Thur	6.00AM	4.00PM	
Fri	6.00AM	4.00PM	Non-standard timings. Where you intend to use the premises for the provision of facilities for entertainment of a similar description to that falling within I or J at different times from those listed in the column on the left, please list (please read guidance note 5)
Sat	6.00AM	4.00PM	
Sun	6.00AM	4.00PM	

L

Late night refreshment			Will the provision of late night refreshment take place indoors or outdoors or both - please tick <input checked="" type="checkbox"/> (please read guidance note 2)
Standard days and timings (please read guidance note 6)			
Day	Start	Finish	Indoors <input checked="" type="checkbox"/> Outdoors <input type="checkbox"/> Both <input type="checkbox"/>
Mon	6.00 AM	4.00 AM	Please give further details here (please read guidance note 3)
	23.00	3.30	
Tue	6.00 AM	4.00 AM	State any seasonal variations for the provision of late night refreshment (please read guidance note 4)
		3.30	
Wed	6.00 AM	4.00 AM	Non-standard timings. Where you intend to use the premises for the provision of late night refreshment at different times from those listed in the column on the left, please list (please read guidance note 5)
		3.30	
Thur	6.00 AM	4.00 AM	
		3.30	
Fri	6.00 AM	4.00 AM	
		3.30	
Sat	6.00 AM	4.00 AM	
		3.30	
Sun	6.00 AM	4.00 AM	
		3.30	

M

Supply of alcohol			Will the sale of alcohol be for consumption - please tick box <input checked="" type="checkbox"/> (please read guidance note 7)
Standard days and timings (please read guidance note 6)			
Day	Start	Finish	On the premises <input checked="" type="checkbox"/> Off the premises <input type="checkbox"/> Both <input type="checkbox"/>
Mon	6.00 AM	4.00 AM	State any seasonal variations for the supply of alcohol (please read guidance note 4)
		3.30	
Tue	6.00 AM	4.00 AM	
		3.30	
Wed	6.00 AM	4.00 AM	Non-standard timings. Where you intend to use the premises for the supply of alcohol at different times from those listed in the column on the left, please list (please read guidance note 5)
		3.30	
Thur	6.00 AM	4.00 AM	
		3.30	
Fri	6.00 AM	4.00 AM	
		3.30	
Sat	6.00 AM	4.00 AM	
		3.30	
Sun	6.00 AM	4.00 AM	
		3.30	

N

Please highlight any adult entertainment or services, activities, other entertainment or matters ancillary to the use of the premises that may give rise to concern in respect of children (please read guidance note 8)

CHILDREN ON PREMISES MUST HAVE WITH THEM THEIR PARENTS, CARERS OR NATURAL RELATIVES AND MUST BE GUIDED BY THEM & MANAGEMENTS WAITS AT THE PREMISES

O

Hours premises are open to the public
Standard days and timings (please read guidance note 6)

Day	Start	Finish
Mon	6.00 AM	4.00 AM
Tue	6.00 AM	4.00 AM
Wed	6.00 AM	4.00 AM
Thur	6.00 AM	4.00 AM
Fri	6.00 AM	4.00 AM
Sat	6.00 AM	4.00 AM
Sun	6.00 AM	4.00 AM

State any seasonal variation (please read guidance note 4)

Non-standard timings. Where you intend to use the premises to be open to the public at different times from those listed in the column on the left, please list (please read guidance note 5)

Please identify those conditions currently imposed on the licence which you believe could be removed as a consequence of the proposed variation you are seeking

X/A

Please tick yes

I have enclosed the premises licence

I have enclosed the relevant part of the premises licence

If you have not ticked one of these boxes please fill in reasons for not including the licence, or part of it, below

Reasons why I have failed to enclose the premises licence or relevant part of the premises licence

X/A

P Describe any additional steps you intend to take to promote the four licensing objectives as a result of the proposed variation:

a) General - all four licensing objectives (b, c, d, e) (please read guidance note 9)

WE HAVE IN PLACE MEASURES THAT SHOULD MAKE ALL CUSTOMERS TO ENJOY THE TV

b) The prevention of crime and disorder

THE PREMISES HAS CLOSED CIRCUIT TRANSMISSION VIDEO CAMERAS IN PLACE AS A DEFENSE TO ALL USERS OF THE PLACE. STRICT REGIME/MEASURES ARE BEING OBSERVED AT ALL TIMES.

c) Public safety

THE LAYOUT IS WELL LOOKED AFTER AT ALL TIMES AND CUSTOMERS ALWAYS REMINDED OF THEIR RESPONSIBILITIES AND OTHER USERS WHOSE AT THE PREMISES NOT TO ALLOW ANYBODY TO USE ANY DRUGS OR ENGAGE IN NOISE NUISANCE OR CREATE A SITUATION THAT CAN ENDANGER THEMSELVES OR OTHERS WHOSE AT THE PREMISES

d) The prevention of public nuisance

HIGHLIGHTING AND IMPLEMENTING OF MEASURES THAT DONT WARRANT USE OF VIOLENCE & DRUGS IN ANY FORM OR SHAPE. THIS ALLOWS US TO MAKE SURE INFORMATION TO DETER (STOP ANY OF SUCH ACTIVITIES BY CUSTOMERS IS IN PLACE

e) The protection of children from harm

WE HAVE MEASURES IN PLACE TO MAKE SURE NO UNLAWFUL AND KNOWNLY NEGLECT, ABUSE OR EXPOSING CHILDREN TO UNLAWFUL AND BEHAVIOURS THAT ARE UNLAWFUL WHOSE AT THE PREMISES THIS HAS TO BE STRICTLY OBSERVED AT ALL TIMES

Please tick yes

- I have made or enclosed payment of the fee
- I have sent copies of this application and the plan to responsible authorities and others where applicable
- I understand that I must now advertise my application
- I have enclosed the premises licence or relevant part of it or explanation
- I understand that if I do not comply with the above requirements my application will be rejected

IT IS AN OFFENCE, LIABLE ON CONVICTION TO A FINE UP TO LEVEL 5 ON THE STANDARD SCALE, UNDER SECTION 158 OF THE LICENSING ACT 2003 TO MAKE A FALSE STATEMENT IN OR IN CONNECTION WITH THIS APPLICATION

Part 5 - Signatures (please read guidance note 10)

Signature of applicant (the current premises licence holder) or applicant's solicitor or other duly authorised agent. (please read guidance note 11)

If signing on behalf of the applicant please state in what capacity.

Signature

[Handwritten signature]

Date

11/11/2015

Capacity

Manager

Where the premises licence is jointly held signature of 2nd applicant (the current premises licence holder) or 2nd applicant's solicitor or other authorised agent. (please read guidance note 12)

If signing on behalf of the applicant please state in what capacity.

Signature

Date

Capacity

Contact name (where not previously given) and address for correspondence associated with this application (please read guidance note 13)

Post town

Postcode

Telephone number (if any)

If you would prefer us to correspond with you by e-mail your e-mail address (optional)

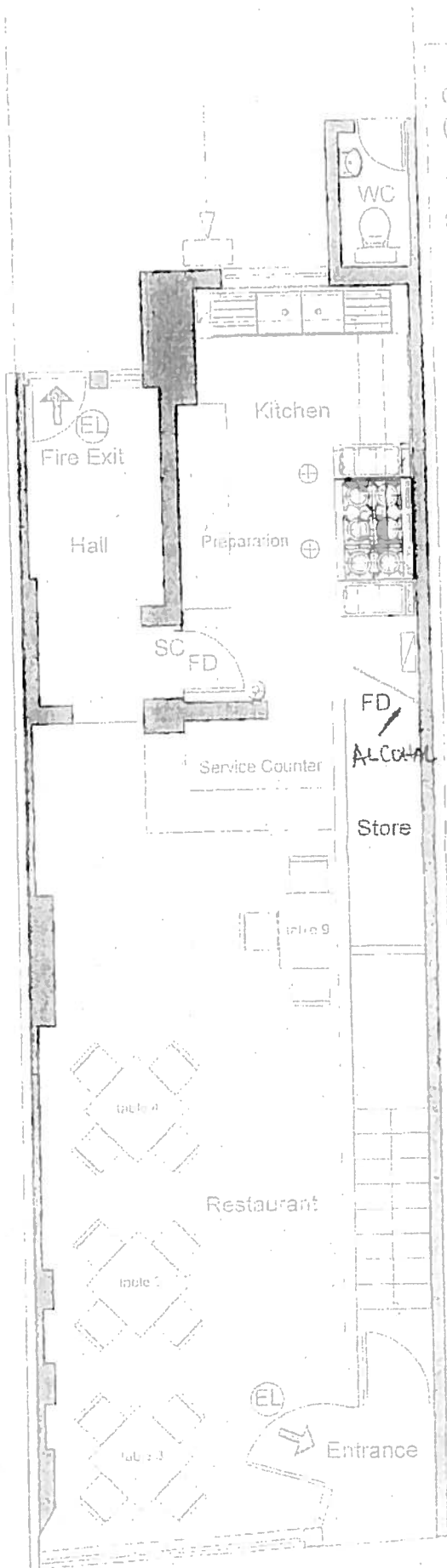

**Cooker Extract Details:
(Commercial Stainless Steel)**

1. Canopy size 920mmx1530mm
2. Air Speed moving across face of canopy 1000f/min, providing escape volume of 3.94 cu.M/sec
3. Speed of stale air moving through extract duct = 1000f/min
4. Canopy incorporates condense channel all around and contains 3-4 Nos. bottle type grease filters, 2 Nos. bulk head lights of 100 watts each.

Duct Details:

GSS extract picks up stale air from the canopy then runs tight to ceiling and through carbon filter above the flat roof and fitted with AV mounted fans. At Exit a silencer will be fitted in order to reduce noise. It then discharges the stale air 2.0 metres above eaves line on the main building as shown on rear elevation.

LEGEND:

- Emergency Lighting
- Fire Escape Route
- Mains operated interlinked smoke detector
- Mains operated interlinked smoke detector
- Fire Blankets
- Self-Closing Door
- 1/2 hr Fire Door
- Fire Extinguisher

Ground Floor - Proposed

Appendix 1A- Copy of existing Premises Licence.



PREMISES LICENCE SUMMARY

Receipt: AG1074842

Premises Licence Number: LN/000013122

This Premises Licence has been issued by:

The Licensing Authority, London Borough of Haringey,
6th Floor Alexandra House, 10 Station Road,
Wood Green, London, N22 7TR

Signature:.....

Date: 28th August 2014
15th June 2015

Part 1 – PREMISES DETAILS

Postal Address of Premises or, if none, Ordnance Survey map reference or description:

THE VILLAGE
118 WEST GREEN ROAD
TOTTENHAM
LONDON
N15 5AA

Telephone: 020 3601 7474

Where the Licence is time limited, the dates:

Not applicable

Licensable activities authorised by the Licence:

Supply of Alcohol

The times the Licence authorises the carrying out of licensable activities:

Supply of Alcohol

Sunday to Thursday 1200 to 2230

Friday to Saturday 1200 to 0000

The opening hours of the premises:

Sunday to Thursday 1200 to 2300

Friday to Saturday 1200 to 0030

Where the Licence authorises supplies of alcohol whether these are on and/or off supplies:

Supply of alcohol for consumption ON the premises, ancillary to a meal



PREMISES DETAILS [CONT'D]

Name, (registered) address of holder of Premises Licence:

Mediwa Basirika
23 Mount Pleasant Road
Tottenham
London
N17 6TR

Registered number of holder, for example company number, charity number (where applicable):

Not applicable

Name of designated premises supervisor where the Premises Licence authorises the supply of alcohol:

Mediwa Basirika

State whether access to the premises by children is restricted or prohibited:

Only children accompanied by an adult are permitted on the premises



Haringey Council

PREMISES LICENCE

Receipt: AG1074842

Premises Licence Number: LN/000013122

This Premises Licence has been issued by:

**The Licensing Authority, London Borough of Haringey,
6th Floor Alexandra House, 10 Station Road,
Wood Green, London, N22 7TR**

Signature:.....*E. M. C. L. A.*.....

Date: 28th August 2014
15th June 2015

Part 1 – PREMISES DETAILS

Postal Address of Premises or, if none, Ordnance Survey map reference or description:

**THE VILLAGE
118 WEST GREEN ROAD
TOTTENHAM
LONDON
N15 5AA**

Telephone: 020 3601 7474

Where the Licence is time limited, the dates:

Not applicable

Licensable activities authorised by the Licence:

Supply of Alcohol

The times the Licence authorises the carrying out of licensable activities:

Supply of Alcohol

Sunday to Thursday 1200 to 2230

Friday to Saturday 1200 to 0000

The opening hours of the premises:

Sunday to Thursday 1200 to 2300

Friday to Saturday 1200 to 0030

Where the Licence authorises supplies of alcohol whether these are on and/or off supplies:

Supply of alcohol for consumption **ON** the premises, ancillary to a meal



Part 2

Name, (registered) address, telephone number and e-mail (where relevant) of holder of Premises Licence:

Mediwa Basirika
23 Mount Pleasant Road
Tottenham
London
N17 6TR

Registered number of holder, for example company number, charity number (where applicable):

Not applicable

Name, address and telephone number of designated premises supervisor where the Premises Licence authorises the supply of alcohol:

Mediwa Basirika
23 Mount Pleasant Road
Tottenham
London
N17 6TR

Personal Licence number and issuing authority of personal licence held by designated premises supervisor where the Premises Licence authorises for the supply of alcohol:

Personal Licence: LN/000007070
Issued by: The London Borough of Haringey

Annex 1 –Mandatory Conditions

1. No supply of alcohol may be made under the Premises Licence –
 - (a) At a time when there is no Designated Premises Supervisor in respect of the Premises Licence; or
 - (b) At a time when the Designated Premises Supervisor does not hold a Personal Licence or his Personal Licence is suspended.
2. Every supply of alcohol under the Premises Licence must be made, or authorised by a person who holds a Personal Licence.
3. (1) The responsible person must ensure that staff on relevant premises do not carry out, arrange or participate in any irresponsible promotions in relation to the premises.
 - (2) In this paragraph, an irresponsible promotion means any one or more of the following activities, or substantially similar activities, carried on for the purpose of encouraging the sale or supply of alcohol for consumption on the premises.
 - a) games or other activities which require or encourage, or are designed to require or encourage, individuals to –
 - (i) drink a quantity of alcohol within a time limit (other than to drink alcohol sold or supplied on the premises before the cessation of the period in which the responsible person is authorised to sell or supply alcohol), or
 - (ii) drink as much alcohol as possible (whether within a time limit or otherwise);
 - b) provision of unlimited or unspecified quantities of alcohol free or for a fixed or discounted fee to the public or to a group defined by a particular characteristic in a manner which carries a significant risk of undermining a licensing objective;
 - c) provision of free or discounted alcohol or any other thing as a prize to encourage or reward the purchase and consumption of alcohol over a period of 24 hours or less in a manner which carries a significant risk of undermining a licensing objective;
 - d) selling or supplying alcohol in association with promotional posters or flyers on, or in the vicinity of, the premises which can reasonably be considered to condone, encourage or glamorise anti-social behaviour or to refer to the effects of drunkenness in any favourable manner.
 - e) dispensing alcohol directly by one person into the mouth of another (other than where that other person is unable to drink without assistance by reason of disability).
4. The responsible person must ensure that free potable water is provided on request to customers where it is reasonably available.
5. (1) The premises licence holder or club premises certificate holder must ensure that an age verification policy is adopted in respect of the premises in relation to the sale or supply of alcohol.
 - (2) The designated premises supervisor in relation to the premises licences must ensure that the supply of alcohol at the premises is carried on in accordance with the age verification policy.

Annex 1 –Mandatory Conditions

(3) The policy must require individuals who appear to the responsible person to be under 18 years of age (or such older age as may be specified in the policy) to produce on request, before being served alcohol, identification bearing their photograph, date of birth and either:-

- (a) a holographic mark or
- (b) an ultraviolet feature.

6. The responsible person shall ensure that –

- (a) where any of the following alcoholic drinks is sold or supplied for consumption on the premises (other than alcoholic drinks sold or supplied having been made up in advance ready for sale or supply in a securely closed container) it is available to customers in the following measures –
 - (i) beer or cider: ½ pint;
 - (ii) gin, rum, vodka or whisky: 25 ml or 35 ml; and
 - (iii) still wine in a glass: 125 ml; and
- (b) these measures are displayed in a menu, price list or other printed material which is available to customers on the premises; and
- (c) where a customer does not in relation to a sale of alcohol specify the quantity of alcohol to be sold, the customer is made aware that these measures are available.

Minimum Drinks Pricing

1. A relevant person shall ensure that no alcohol is sold or supplied for consumption on or off the premises for a price which is less than the permitted price.

2. For the purposes of the condition set out in paragraph 1 –

- (a) “duty” is to be construed in accordance with the Alcoholic Liquor Duties Act 1979
- (b) “permitted price” is the price found by applying the formula –

$$P = D + (D \times V)$$

Where –

- (i) P is the permitted price
 - (ii) D is the amount of duty chargeable in relation to the alcohol as if the duty were charged on the date of the sale or supply of the alcohol, and
 - (iii) V is the rate of value added tax chargeable in relation to the alcohol as if the value added tax were charged on the date of the sale or supply of the alcohol;
- (c) “relevant person” means, in relation to premises in respect of which there is in force a premises licence –

- (i) The holder of the premises licence
- (ii) The designated premises supervisor (if any) in respect of such a licence, or
- (iii) The personal licence holder who makes or authorises a supply of alcohol under such a licence;

Annex 1 –Mandatory Conditions

- (d) "relevant person" means, in relation to premises in respect of which there is in force a club premises certificate, any member or officer of the club present on the premises in a capacity which enables the member or officer to prevent the supply in question; and
- (e) "value added tax" means value added tax charged in accordance with the Value Added Tax Act 1994.
3. Where the permitted price given by Paragraph (b) of paragraph 2 would (apart from the paragraph) not be a whole number of pennies, the price given by that sub-paragraph shall be taken to be the price actually given by that sub-paragraph rounded up to the nearest penny.
4. (1) Sub-paragraph (2) applies where the permitted price given by Paragraph (b) of paragraph 2 on a day ("the first day") would be different from the permitted price on the next day ("the second day") as a result of a change to the rate of duty or value added tax.
- (2) The permitted price which would apply on the first day applies to sales or supplies of alcohol which take place before the expiry of the period of 14 days beginning on the second day.

RESTAURANT CONDITION:

Intoxicating liquor shall not be sold or supplied on the premises otherwise than to persons taking table meals there and for consumption by such a person ancillary to his meal.

Suitable beverages other than intoxicating liquor (including drinking water) shall be equally available for consumption with or otherwise as an ancillary to meals served in the licensed premises

Annex 2 – Conditions consistent with the Operating Schedule

THE PREVENTION OF CRIME AND DISORDER

A digital CCTV system will be installed in the premises.

Cameras must be sited to observe the entrance doors from inside.

Cameras on the entrances must capture full frame shots of the heads and shoulders of all people entering the premises i.e. capable of identification.

Provide a linked record of the date, time, and place of any image.

Provide good quality images - colour during opening times.

Have a monitor to review images and recorded quality.

Be regularly maintained to ensure continuous quality of image capture and retention.

Staff trained in operating CCTV.

Digital images must be kept for 31 days. The equipment must have a suitable export method, e.g. CD/DVD writer so that Police can make an evidential copy of the data they require. Copies must be available within a reasonable time to Police on request.

An incident log shall be kept at the premises, it will be in a hardback durable format handwritten at the time of the incident or as near to as is reasonable and made available on request to the Police, which will record the following:

- (a) all crimes reported to the venue
- (b) all ejections of patrons
- (c) any complaints received
- (d) any incidents of disorder
- (e) seizures of drugs or offensive weapons
- (f) any faults in the CCTV system
- (g) any refusal of the sale of alcohol
- (h) any visit by a relevant authority or emergency service

No sale or supply of hot food or drink will be permitted after 23.00pm

All alcohol sales will be ancillary to substantial food.

No customers are permitted entry after 23.00pm

No more than three customers are permitted at the front of the premises to smoke at any one time.

No drinks are permitted to be taken outside of the premises

The following hours will apply:

Supply of alcohol:

Friday to Saturday- 12.00 to Midnight

Hours open to the public:

Friday to Saturday- 12.00 to 00.30

Staff will undergo training to acquire awareness of how to prevent crime and disorder and prevention of drug sales on the premises.

The Licensee will cooperate with the police when required.

PUBLIC SAFETY

Clear and legible signage will be displayed

Annex 2 – Conditions consistent with the Operating Schedule

Health and Safety standards will be met on the premises.

Inspection certificates will be kept on the premises.

THE PREVENTION OF PUBLIC NUISANCE

Prevention of nuisance from noise / vibration

The entrance door will be fitted with a self-closing device and staff required to ensure that it is not propped open. A member of staff shall be made responsible to ensure the door is opened for as brief a period as possible. Where necessary adequate and suitable mechanical ventilation should be provided to public areas

Structure borne noise

All speakers are mounted on anti-vibration mountings to prevent vibration transmission of sound energy to adjoining properties

Outside Areas

No music will be played in, or for the benefit of patrons in external areas of the premises

No form of loudspeaker or sound amplification equipment is to be sited on or near the exterior premises or in or near any foyer, doorway, window or opening to the premises

Signs shall be displayed in the external areas/on the frontage requesting patrons to recognise the residential nature of the area and conduct their behaviour accordingly. The management must reserve the right to ask patrons to move inside the premises or leave if it is felt that they could be disturbing neighbours

Deliveries and collections

Deliveries and collections associated with the premises will be arranged between the hours 08:00-20:00 so as to minimise the disturbance caused to the neighbours

Empty bottles and non-degradable refuse will remain in the premises at the end of trading hours and taken out to the refuse point at the start of the working day rather than at the end of trading when neighbours might be unduly disturbed

Plant and machinery

All plant and machinery is correctly maintained and regularly serviced to ensure that it is operating efficiently and with minimal disturbance to neighbours arising from noise

Dealing with complaints

A complaints book will be held on the premises to record details of any complaints received from neighbours. The information is to include, where disclosed, the complainant's name, location, date time and subsequent remedial action undertaken. This record must be made available at all times for inspection by council officers

Patrons entering/exiting premises

There will be no queuing outside the premises.

Where people queue to enter the premises a licensed door supervisor shall supervise and ensure the potential patrons behave in an acceptable manner

Annex 2 – Conditions consistent with the Operating Schedule

Signs should be displayed requesting patrons to respect the neighbours and behave in a courteous manner

Prevention of nuisance from litter

Adequate receptacles for use by patrons will be provided.

Prevention of Nuisance from Odour

All ventilation and extraction systems shall be correctly maintained and regularly serviced to ensure that it is operating efficiently and with minimal disturbance to neighbours arising from odour.

Prevention of nuisance from light

Illuminated external signage shall be switched off when the premises is closed

Security lights will be positioned to minimise light intrusion to nearby residential premises.

Prominent, clear and legible notices will be displayed at all exits requesting the public to respect the needs of local residents and to leave the premises and the area quietly.

THE PROTECTION OF CHILDREN

Alcohol may only be sold to individuals over the age of 18 with valid proof of identification with one of the following:

- A valid passport
- A photo driving license issued in a European Union Country
- A proof of age standard card system
- A citizen card, supported by the Home Office

All relevant staff will be regularly trained in the prevention of underage sales including; knowledge of the law and guidance on how to assess age and recognise acceptable ID. Such ID must bear a photograph, date of birth and a holographic mark

A written record will be kept of staff training confirming they have understood the legal requirement

A refusals register will be kept available for inspection by authorised officers

The 'Challenge 21' policy will be implemented.

Only children accompanied by an adult are permitted on the premises.

Annex 3 – Conditions attached after a hearing by the licensing authority

Not applicable

Annex 4 - Plans

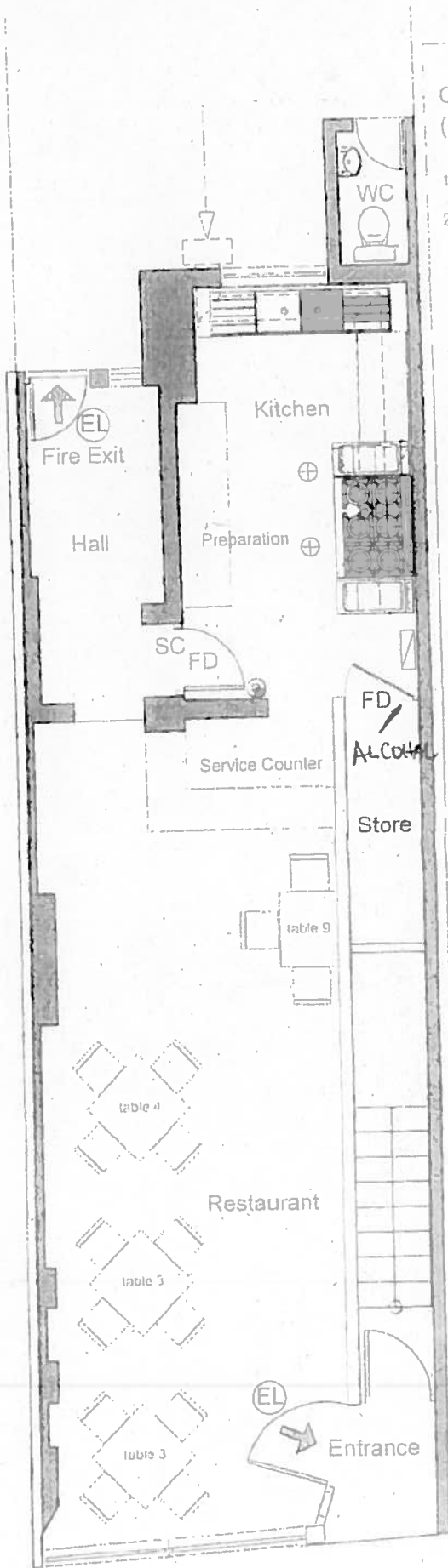

Cooker Extract Details: (Commercial Stainless Steel)

- 1 Canopy size 920mmx1530mm
2. Air Speed moving across face of canopy 100ft/min, providing escape volume of 0.94 cu.M/sec'
- 3 Speed of stale air moving through extract duct = 1000ft/min
- 4 Canopy incorporates condense channel all around and contains 3-4 Nos. baffle type grease filters, 2 Nos. bulk head lights of 100 watts each.

Duct Details:

GSS extract picks up stale air from the canopy, then runs tight to ceiling and through carbon filter above the flat roof and fitted with AV mounted fans. At Exit a silencer will be fitted in order to reduce noise. It then discharges the stale air 2.0 metres above eaves line on the main building as shown on rear elevation.

LEGEND:

- (EL) Emergency Lighting
- Fire Escape Route
- ⊕ SD Mains operated interlinked smoke detector
- ⊕ HD Mains operated interlinked smoke detector
- ▭ Fire Blankets
- SC Self-Closing Door
- FD 1/2 hr Fire Door
- ⊙ Fire Extinguisher

Ground Floor - Proposed

AUTOMATIC FIRE ALARM (BS 5839 Part

Appendix 2 – Letter of representation from Licensing Authority

Ref:

Date: 24th November 2015

Miss Mediwa Basirika
The Village
118A West Green Road
Tottenham
London
N15 5AA

Dear Sir/Madam,

RE: APPLICATION FOR A PREMISES LICENCE FOR THE VILLAGE, 118 WEST GREEN ROAD, TOTTENHAM, LONDON, N15 5AA - REPRESENTATION

I am writing to make representation in regard to your application for a variation of the premise at The Village, 118 West Green Road London N15. The conditions offered in the application form do not reflect any consideration being given to the make up of the local area and the potential impact the business may have if it were to go for later hours.

In determining what conditions are appropriate, it will be necessary to consider the individual circumstances of the premises, including:-

- The nature and style of the venue,
- The activities being conducted there,
- The location, and,
- Anticipated clientele.

We are unable to support any increase in hours at this premises as we feel that the premises is not suitable for the extended hours now being requested by the applicant. The application is seeking to offer regulated entertainment to the early hours of the morning also. We feel that the close proximity of residential premises will be severely impacted by any such additional activity and or increase in hours.

We feel that the following hours should apply:

Supply of Alcohol	
Sunday to Thursday	1200 to 2230
Friday to Saturday	1200 to 0000

Supply of alcohol for consumption **ON** the premises, ancillary to a meal

Regulated Entertainment:

Live Music should be limited to:
Sunday-Saturday 1200 to 22.00

Late Night Refreshment
Friday-Saturday only 23.00-23.30pm

The opening hours of the premises:

Sunday to Thursday	1200 to 2300
Friday to Saturday	1200 to 0030

The premises was visited on Friday 20th November at which time the licensee was unable to tell us what the times on the current licence was for licensable activity. When asked what time she stopped serving food she replied '1am sometimes earlier'. We had to then point out that the licence did not provide for late night refreshment currently and that the premises was to be closing at 12.30am under the current licence.

The CCTV system on the premises was also not adequate and could not be operated by the Licensee.

The music being played within the premises could be heard from outside and would certainly be intrusive to the nearest residential properties. The entrance to the premises is also next to the entrance to the residential properties above. The premises is not suitable for late night music as the fabric of the building offers no protection from noise break out from the restaurant.

The Authority also considers that it is imperative to have a balance between the needs of the business and the needs of local residents to ensure there is no adverse impact on the community.

Licensing Authority

Licensing Team
Level 6, Alexandra House
10 Station Road
London, N22 7TR

T 020 8489 8232
E licensing@haringey.gov.uk

www.haringey.gov.uk

Haringey Council – Enforcement Response team Observation Record

Date: *2³/14* Prosecution ref: WK Complaint ref: WK *27/14 9/11*
Time rec'd: *0304* FPN ref: WK Notice ref: WK

Noise from Address: *118 West Green Rd. 115* HfH PSL
single family house / flat O/Occ Priv Rent
RSL Non-domestic

Type of Noise: Music / Voices ./ Alarm / Dog / Banging / Ventilation / Other

Complainant's Details
Name: *Mark Arevalo* HfH PSL
Address: *118 West Green Rd* O/Occ Priv Rent
Tel no: *07554 426 335* RSL Non-domestic

History Check (Complete this before visit)
i) On Action List? Yes No WL / S 80 / S 60 / Prosecution / Caution / SWL / FPN
and date

ii) On potentially violent (PV) List? Yes No
Instructions if on PV list:

Telephone Calls to Complainant: Time: *0310* Result of Call: *Dist.*
Time: Result of Call:
Time: Result of Call:
Visit to Complainant / Area: Arrival Time: *0329* Departure Time: *Rept.*
Occupier Name Tenancy commenced Date:
Source of Information: Council Tax / NNDR HfH OHMS RSL name

If HfH or RSL: name of TMO or Housing Manager
NS21 October 2013

Observations

Attended location, found premises still open with approx 20 people inside, eating and drinking.

Spoke to male in charge who stated it was a wedding party, running late and were having something to eat and drink. No trace of premises cooking or serving drinks (Party brought in from fr.)

Refused make re-planning time limits. No music being played on site, although did notice a DJ mixer setup behind counter. Refused make to inform owner matter will be reported.

M3 multi source outcome codes

- DN01 No visit - noise stopped
- DN02 No visit - other
- DN03 No visit - out of remit
- DN12 No visit - call cancelled
- DN13 No time to visit
- DN14 No visit - no response complainant
- DN04 Nuisance confirmed, reported
- DN05 Nuisance confirmed abated
- DN06 Nuisance not established
- DN09 No officer on duty
- DN07 Noise not on now response
- DN08 Proactive completed
- DN10 Licensing response
- DN11 Planning response

Action: 1st Advisory letter / EPA - WL / EPA S80 notice / CoPA letter / CoPA S60 notice

ASBAT referral / Special WL following notice / Offence / FPN / Other: circle all that apply

I certify that the enforcement action taken is in accordance with the Council's enforcement policy

Signed: *[Signature]* Name: *C. Buehler* Date: *2/14*

Haringey Council – Enforcement Response team Observation Record

Date: 28th/14 Prosecution ref: WK Complaint ref: WK 271219
Time rec'd: 2310 FPN ref: WK Notice ref: WK

Noise from Address: 118 West Gen Rd N15
single family house / flat HfH PSL
O/Occ Priv Rent
RSL Non-domestic

Type of Noise: Music / Voices / Alarm / Dog / Banging / Ventilation / Other

Complainant's Details
Name: No active HfH PSL
Address: O/Occ Priv Rent
Tel no: RSL Non-domestic

History Check (Complete this before visit)
i) On Action List? Yes No WL / S 80 / S 60 / Prosecution / Caution / SWL / FPN
and date

ii) On potentially violent (PV) List? Yes No
Instructions if on PV list:

Telephone Calls to Complainant: Time: Result of Call:
Time: Result of Call:
Time: Result of Call:
Visit to Complainant / Area: Arrival Time: 2310 Departure Time: 16:50
Occupier Name Tenancy commenced Date:

Source of Information: Council Tax / NNDR HfH OHMS RSL name

If HfH or RSL: name of TMO or Housing Manager

Observations

Attended premises on a proactive visit, as a result of information received from Planning concerning opening hours, and licensing re beer at the pub.

Attended at 23.0, approx 56 people inside taking no food being cooked or consumed. No music being played either.

Spoke to a male allegedly in charge, advised him re planning time limits on property. He wouldn't agree that it was till 2300, even though it was after that on my visit. Offered him to inform owner matter will be reported for breach of conditions.

M3 multi source outcome codes

- | | | |
|---|----------------------------------|-------------------------|
| DN01 No visit - noise stopped | DN04 Nuisance confirmed reported | DN10 Licensing response |
| DN02 No visit - other | DN05 Nuisance confirmed abated | DN11 Planning response |
| DN03 No visit - out of remit | DN06 Nuisance not established | |
| DN12 No visit - call cancelled | DN09 No officer on duty | |
| DN13 No time to visit | DN07 Noise not on now response | |
| DN14 No visit - no response complainant | DN08 Proactive completed | |

Action: 1st Advisory letter / EPA - WL / EPA S80 notice / CoPA letter / CoPA S60 notice

ASBAT referral / Special WL following notice / Offence / FPN / Other circle all that apply

I certify that the enforcement action taken is in accordance with the Council's enforcement policy

Signed: [Signature] Name: [Signature] Date: 28/4

Planning Enforcement
Planning & Regeneration
Place and Sustainability Directorate
6th Floor
River Park House
225 High Road
London
N22 8HQ

A large rectangular area of the document is redacted with thick blue ink, obscuring several lines of text.

12 January 2014

Dear Sir/Madam,

**PREMISES LICENCE BREACHES/NOISE NUISANCE AND CLUB-TYPE ACTIVITY
SHOP AT 118 WEST GREEN ROAD, LONDON N15 5AA**

The above opened as a takeaway in September 2013 and has been a continual noise nuisance since this time. I have reported it to the Haringey Noise Team several times, who visited and issued two separate warnings to the proprietor George Akolbire. Unfortunately, the nuisance still continues and the warnings have had no effect.

We understand that Mr Akolbire only has planning permission to operate until 11pm, which was kindly confirmed by Daliah Barrett, Licensing Manager at Haringey Council. However, the music, cooking/customer activity/shouting/banging usually goes on to between 1.00am and 2.30am on most days, sometimes 3.30am at weekends.

Please can you let me know if it's possible for Haringey Council to order/serve notice to Mr Akolbire to finish trading at 11pm as per his licence? I have kept a record of activity for December and started January (attached).

Yours faithfully,

A large area of the document is redacted with thick blue ink, obscuring the signature and any text below it.

Alleged Noise Nuisance/Out of Hours/Licence Trading Diary

Signed:



Date: 12 January 2014

Address where noise originates: Shop at 118 West Green Road, N15 5AA

This log is true to the best of my knowledge and belief and I make it known that if tendered in evidence, I shall be liable to prosecution if I have wilfully stated anything in it which I know to be false or do not believe to be true.

Date	Duration Times		Description of Noise	How does the noise affect you
1-12-13	15.00	03.30	Very loud music, shouting, banging **	Daytime; cannot escape constant booming through everything in the flat, tv, etc. Impossible to concentrate on anything, relax or have a conversation between ourselves. Living to constant soundtrack. Evening/Late night/Early morning; cannot relax or sleep for noise. Losing sleep, feeling tired, becoming anxious, losing concentration and resultant stress at work. Never look forward to coming home and relaxing in anymore.
3-12-13	18.00	01.30	Loud music, banging **	
4-12-13	18.00	00.30	Loud music, banging **	
5-12-13	18.00	02.00	Loud music, shouting **	
6-12-13	16.00	02.30	Very loud music, shouting, T372677 *	
7-12-13	18.30	01.00	Loud music **	
8-12-13	14.30	03.30	Very loud music, shouting, banging **	
Away				
14-12-13	15.50	00.20	Very loud music, shouting, T379 453 *	* Council Noise Team call ref. * Noise Team visit/formal warnings ** Called proprietor to turn down
15-12-13	14.45	18.30	Very loud music, shouting, T380 456 *	
18-12-13	18.00	00.15	Loud music, banging **	
20-12-13	17.30	23.25	Very loud music, shouting, T384 668 * * * **	
21-12-13	18.30	02.30	Loud music, banging **	
22-12-13	?	01.25	Loud music, T? lost ref *	
Away				
26-12-13	15.20	18.15	Very loud music, shouting, T391 781 * * * **	
27-12-13	17.30	00.45	Loud music, banging **	
28-12-13	14.30	01.30	Loud music, banging **	
29-12-13	15.00	18.30	Very loud music, shouting T397 133M5H *	

Alleged Noise Nuisance/Out of Hours/Licence Trading Diary

Signed: 

Date: 12.1.14

Address where noise originates: Shop at 118 West Green Road, N15 5AA

This log is true to the best of my knowledge and belief and I make it known that if tendered in evidence, I shall be liable to prosecution if I have wilfully stated anything in it which I know to be false or do not believe to be true.

Date	Duration Times	Description of Noise	How does the noise affect you
------	----------------	----------------------	-------------------------------

10-1-2014	19.00 01.30	Loud music. banging **	<p>Daytime; cannot escape constant booming through everything in the flat, tv, etc. Impossible to concentrate on anything, relax or have a conversation between ourselves. Living to constant soundtrack.</p> <p>Evening/Late night/Early morning; cannot relax or sleep for noise.</p> <p>Losing sleep, feeling tired, becoming anxious, losing concentration and resultant stress at work.</p> <p>Never look forward to coming home and relaxing in anymore.</p>
11-1-2014	19.00 02.00	Loud music, banging, noise to 03.00 **	

Daytime; cannot escape constant booming through everything in the flat, tv, etc. Impossible to concentrate on anything, relax or have a conversation between ourselves. Living to constant soundtrack.

Evening/Late night/Early morning; cannot relax or sleep for noise.

Losing sleep, feeling tired, becoming anxious, losing concentration and resultant stress at work.

Never look forward to coming home and relaxing in anymore.

- * Council Noise Team call ref.
- * Noise Team visit/formal warnings
- ** Called proprietor to turn down

Appendix 3- Letter of representation from Met Police.



METROPOLITAN
POLICE

TOTAL POLICING

TERRITORIAL POLICING

YR - Haringey Borough

Mrs D Barrett

Haringey Council Licensing
Alexandra House
Station Road
London N22

Quicksilver Patrol Base
Unit 1 Quicksilver Place
Western Road
London
N22 6UH

Telephone: 020 32760150

Email: Mark.Greaves@met.police.uk
www.met.police.uk

7th December 2015

Dear Mrs Barrett

POLICE OBJECTION NOTICE to a Variation of a Premises Licence

Name of Licence holder: Mediwa Basirika

Venue: The Village, 118 West Green Road N15

This application relates to an increase in operating hours from:

Supply of alcohol: Sunday - Thursday 1200 - 2230 Friday to Saturday 1200 - 0000

Opening Hours: Sunday - Thursday 1200 - 2300 Friday - to Saturday 1200 - 0030

To:

Supply of alcohol: Sunday - Saturday 0600 - 0330 Opening Hours: Sunday - Saturday 0600 - 0400
with music throughout opening hours.

Myself and Daliah Barrett visited the venue at 2230 on Friday 20th November 2015 and met Ms Basirika. A Condition on the premises Licence states: 'All alcohol sales will be ancillary to substantial food.' I saw 9 clients with alcohol and 2 of them had empty plates on their table. Ms Basirika assured me everyone had finished their meal.

The Premises Licence has a Condition that there should be an 'Incident Book' but Ms Basirika did not have one. The Premises Licence has a Condition relating to CCTV standards including 'full frame head shots of persons entering but Cam 2 covering the door was average quality but did not record images as required, image was of full person entering so smaller facial image. Cam 1 recorded inside venue seating area and was poor quality with unidentifiable images. Cam 3 was poor quality and covered behind the counter. Cam 4 was poor quality and covered rear yard of venue. I asked about facilities to burn off images for Police, as per licence, but Ms Basirika know nothing about the CCTV system and neither she nor anyone else in venue could operate the system to show images of previous events as required on Licence. She told me her brother could operate the CCTV.

When Ms Barrett asked her what time she stopped serving she replied 'I am sometimes earlier'. Ms Barrett pointed out the licence did not contain late night refreshment entitlement. I asked Ms Basirika if she could turn down the music as it was so loud it was difficult to converse with her and could be heard outside so she did.

Police feel the CCTV system Condition is not being adhered to and neither was the Condition relating to alcohol with food sales. I did ask to view CCTV of the evening to ascertain if the Condition had been adhered to but as stated above Ms Basirika stated she could not operate the system to that extent.

The application is to virtually operate 24 / 7 in a residential area. A similar venue in same street nearby had it's Premises Licence revoked after 2 incidents of serious violence late night / early morning and Police feel Ms Basirikas lack of knowledge / concern regarding the times / conditions on the licence may lead to alcohol crime / disorder in the early hours.

Yours sincerely,

Mark Greaves
Licensing Officer Haringey Police

Appendix 4- Letters of representation from residents.

We need this club, like a hole
in the head! This area
needs to go FORWARD not
BACKWARDS

Your name/address

[Redacted name and address]

Representation on licence application for:

The Village
118A West Green Road
London
N15 5AA

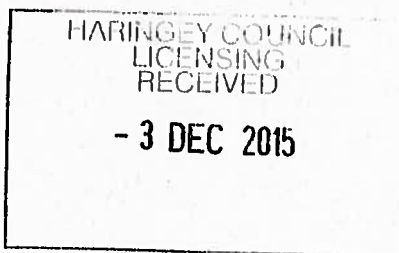

Name of licensee: Medina Basirika

The prevention of crime and disorder/public nuisance

The West Green Road has been a 'sensitive' area for many years and the Council's efforts since the riots (more cameras, upgrading shop fronts, communal garden, etc) have had a positive impact on the local community here. However, there are still regular occurrences of violence and abusive behaviour, and gatherings on the street, particularly at night/early hours of the morning.

As an example, When the Fountain pub (1.30-2.00am on Fridays/Saturdays) closes, a stream of people can be heard shouting, singing and sometimes fighting, cars revving their engines hard, racing, urinating and vomiting. If an additional premises were opened nearby, it would simply act as a focal point for all these people to go to, creating a new centre for determined drinkers from all over the locality.

This part of West Green Road has residential accommodation and also above shops/takeaways. Nearly all the shops operate between normal hours. A club operating all day to 4am would generate disturbing and intrusive levels of noise from music, talking/shouting, people traffic (coming and going), noise of cars parking/leaving all night/morning.

The area is improving slowly, the new flats at Lawrence Square (25 metres away) will bring 1800 new residents and their families from December, this is the kind of neighbourhood I want to live in, not one dominated by a club offering loud music and alcohol until 4 in the morning. It would be a big step backwards and undo the Council's good work here.

Public safety

During the day and night, the presence of customers standing on the street, smoking and intoxicated will cause people to avoid the vicinity, especially mothers with children and the elderly. There are a lot of obviously heavy drinkers in the area and encouraging these people is again a complete step backwards and compromises public safety. The increase in traffic will also put safety at risk in an already busy area.

Protection of children from harm

The area is becoming a better place for children to grow up in, the idea of having a club selling alcohol, purveying loud/club music and resultant anti-social behaviour on their doorstep, next to their homes, where they walk to and from school, does not create a good and safe environment for children.

I, [Redacted] hereby declare that all information I have submitted is true and correct.

Signed: [Redacted signature]

Date: 25th 11. 2015

HARINGEY COUNCIL
LICENSING
RECEIVED

- 3 DEC 2015

Your name/address

Representation on licence application for:

The Village
118A West Green Road
London
N15 5AA

Name of licensee: Medina Basirika

The prevention of crime and disorder/public nuisance

The West Green Road has been a 'sensitive' area for many years and the Council's efforts since the riots (more cameras, upgrading shop fronts, communal garden, etc) have had a positive impact on the local community here. However, there are still regular occurrences of violence and abusive behaviour, and gatherings on the street, particularly at night/early hours of the morning.

As an example, when the Fountain pub (1.30-2.00am on Fridays/Saturdays) closes, a stream of people can be heard shouting, singing and sometimes fighting, cars revving their engines hard, racing, urinating and vomiting. If an additional premises were opened nearby, it would simply act as a focal point for all these people to go to, creating a new centre for determined drinkers from all over the locality.

This part of West Green Road has residential accommodation and also above shops/takeaways. Nearly all the shops operate between normal hours. A club operating all day to 4am would generate disturbing and intrusive levels of noise from music, talking/shouting, people traffic (coming and going), noise of cars parking/leaving all night/morning.

The area is improving slowly, the new flats at Lawrence Square (25 metres away) will bring 1800 new residents and their families from December, this is the kind of neighbourhood I want to live in, not one dominated by a club offering loud music and alcohol until 4 in the morning. It would be a big step backwards and undo the Council's good work here.

Public safety

During the day and night, the presence of customers standing on the street, smoking and intoxicated will cause people to avoid the vicinity, especially mothers with children and the elderly. There are a lot of obviously heavy drinkers in the area and encouraging these people is again a complete step backwards and compromises public safety. The increase in traffic will also put safety at risk in an already busy area.

Protection of children from harm

The area is becoming a better place for children to grow up in, the idea of having a club selling alcohol, purveying loud/club music and resultant anti-social behaviour on their doorstep, next to their homes, where they walk to and from school, does not create a good and safe environment for children.

..... hereby declare that all information I have submitted is true and correct.

Signed:

Date: 25th Nov 2015

LICENSING ACT 2003 - REPRESENTATION FORM

To make a representation in respect of an application for a Premises Licence or Club Premises Certificate please complete the following form. For representations to be considered relevant they must relate to one or more of the four "Licensing Objectives" (listed below).

Please note all representations will be made available for applicants to view. If you make a representation objecting to the application it is likely that you will be called upon to attend a hearing and present your objection before a Licensing Committee.

Personal Details	
Name.....	<div style="border: 1px solid black; padding: 5px; text-align: center;">HARINGEY COUNCIL LICENSING RECEIVED - 3 DEC 2015</div>
Address.....	
Postcode...L.....	

Licence application you wish to make a representation on
<i>You do not need to answer all of the questions in this section, but please give as much information as you can:</i>
Application Number.....
Name of Licensee.....
Name of Premises (if applicable).....THE VILLAGE
Premises Address (where the Licence will take effect)..... 118 A WEST GREEN ROAD.....
Postcode...N15 5AA

Reason/s for representation
<i>Under the Licensing Act 2003, for a representation to be relevant it must be one that is about the likely effect of the application on the promotion of the four licensing objectives. Any representations that are considered to be vexatious or frivolous will not be considered (please see Haringey Council's leaflet Variations, Representations and Appeals for Premises Licences and Club Premises Certificates).</i>
<i>Fill in reason/s for your representation in the space provided under each Licensing Objective it relates to.</i>

The Prevention of Crime and Disorder

The West Green Road has been a sensitive area for crime. In the past years there have been some improvements but a new club operating all day until 4am will bring the crime back. There are a lot of gatherings in the night on the street and a club selling alcohol will make things worse. Also, as a young female citizen I don't feel safe with people drinking and hanging around outside my door.

Public Safety

As said, there are a lot of heavy drinkers in the area who gather together in West Green Road. Normally they are groups of men who are not respectful of the other people living in the area. The opening of a new club with alcohol licence would definitely compromise public safety.

The Prevention of Public Nuisance

The opening of a club with alcohol & live music licences would be detrimental for the area. This is a high street with little local shops that operate normal hours. Also above the shops there are lots of private accommodations who won't be able to sleep in the night with an intrusive level of loud music.

The Protection of Children from Harm

The area is still not ideal for the protection of children and young adults (in particular young female teenagers). The opening of a club that operates till later in the night but also with licence to sell alcohol during the day would ~~bring~~ make the protection of children impossible. Children would experience abusive behaviour on the way to and from school, not to mention the gathering around the club would compromise the traffic at the crossing.

I, [Signature], hereby declare that all information I have submitted is true and correct.

Signed:

[Signature]

Date:

30/11/15

Please send completed form to:

Haringey Council Licensing Team
Alexandra House,
Level 6,
10 Station Road,
Wood Green
London, N22 7TR

From:-

1/12/15

Dear Sir Madam,

Thanks for involving me in this because I live upersit this Resturant and they are very noisey so I am asking you please dont give them no licence for that night club drinkig just keep it quiet in our neighbour hood

Thanks

Yours truly

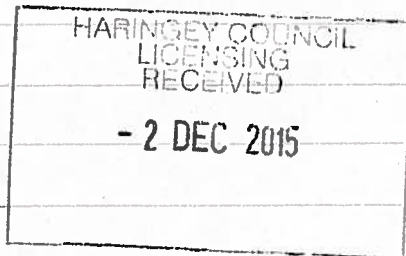

Representation on licence application for:

The Village
118A West Green Road
London
N15 5AA

Name of licensee: Medina Basirika

The prevention of crime and disorder/public nuisance

The West Green Road has been a 'sensitive' area for many years and the Council's efforts since the riots (more cameras, upgrading shop fronts, communal garden, etc) have had a positive impact on the local community here. However, there are still regular occurrences of violence and abusive behaviour, and gatherings on the street, particularly at night/early hours of the morning.

As an example, When the Fountain pub (1.30-2.00am on Fridays/Saturdays) closes, a stream of people can be heard shouting, singing and sometimes fighting, cars revving their engines hard, racing, urinating and vomiting. If an additional premises were opened nearby, it would simply act as a focal point for all these people to go to, creating a new centre for determined drinkers from all over the locality.

This part of West Green Road has residential accommodation and also above shops/takeaways. Nearly all the shops operate between normal hours. A club operating all day to 4am would generate disturbing and intrusive levels of noise from music, talking/shouting, people traffic (coming and going), noise of cars parking/leaving all night/morning.

The area is improving slowly, the new flats at Lawrence Square (25 metres away) will bring 1800 new residents and their families from December, this is the kind of neighbourhood I want to live in, not one dominated by a club offering loud music and alcohol until 4 in the morning. It would be a big step backwards and undo the Council's good work here.

Public safety

During the day and night, the presence of customers standing on the street, smoking and intoxicated will cause people to avoid the vicinity, especially mothers with children and the elderly. There are a lot of obviously heavy drinkers in the area and encouraging these people is again a complete step backwards and compromises public safety. The increase in traffic will also put safety at risk in an already busy area.

Protection of children from harm

The area is becoming a better place for children to grow up in, the idea of having a club selling alcohol, purveying loud/club music and resultant anti-social behaviour on their doorstep, next to their homes, where they walk to and from school, does not create a good and safe environment for children.

I,  hearby declare that all information I have submitted is true and correct.

Signed: 

Date: 18.11.2015

LICENSING ACT 2003 - REPRESENTATION FORM

To make a representation in respect of an application for a Premises Licence or Club Premises Certificate please complete the following form. For representations to be considered relevant they must relate to one or more of the four "Licensing Objectives" (listed below).

Please note all representations will be made available for applicants to view. If you make a representation objecting to the application it is likely that you will be called upon to attend a hearing and present your objection before a Licensing Committee.

Personal Details
Name.....
Address.....
Postcode.....

Licence application you wish to make a representation on
<i>You do not need to answer all of the questions in this section, but please give as much information as you can:</i>
Application Number..... <i>n/a</i>
Name of Licensee..... <i>MEDINA BASIRIKA</i>
Name of Premises (if applicable)..... <i>THE VILLAGE</i>
Premises Address (where the Licence will take effect)..... <i>118A WEST GREEN ROAD, LONDON</i>
Postcode..... <i>N15 5AA</i>

Reason/s for representation
<i>Under the Licensing Act 2003, for a representation to be relevant it must be one that is about the likely effect of the application on the promotion of the four licensing objectives. Any representations that are considered to be vexatious or frivolous will not be considered (please see Haringey Council's leaflet Variations, Representations and Appeals for Premises Licences and Club Premises Certificates).</i>
<i>Fill in reason/s for your representation in the space provided under each Licensing Objective it relates to.</i>

The Prevention of Crime and Disorder

Please see attached

Public Safety

Please see attached

The Prevention of Public Nuisance

Please see attached

The Protection of Children from Harm

Please see attached

I,  hereby declare that all information I have submitted is true and correct.

Signed: 

Date: 18.11.2015

Please send completed form to:

Haringey Council Licensing Team
Alexandra House,
Level 6,
10 Station Road,
Wood Green
London, N22 7TR

REPRESENTATION ON LICENSE APPLICATION FOR:

**The Village
118A West Green Road,
London
N15 5AA**

HARINGEY COUNCIL
LICENSING
RECEIVED

27 NOV 2015

Name of licensee: Medina Basinka

Personal Details

Name: [REDACTED]

Address: [REDACTED]

The Prevention of Crime and Disorder

West Green Road has long been a sensitive area, but the Council's recent efforts have had a positive impact on the local community and the overall character of the neighbourhood, e.g. Improved shop frontages, new public space/garden at Seven Sisters end of the road etc. However there are still regular cases of violence, aggression, intimidating gatherings on the street and anti-social behaviour, particularly at night. The new premises would simply act as an additional focal point for this.

The Prevention of Public Nuisance

This particular part of West Green Road has a lot of residential accommodation, particularly above the shops and on Lawrence Road. We in fact live in Lawrence Yard, which The Village backs on to, and this is already a rather unpleasant place, attracting a variety of unsavoury activity, suspicious/antisocial behaviour and probable criminality. We already have to put up with people urinating/vomiting in the lane, talking and shouting during the night, cars revving and loud music from parties. The new establishment would make this much worse, particularly the intrusion of loud club music on a nightly basis.

Public Safety

West Green Road is already quite an aggressive environment. The new premises would lead to customers standing on the street, smoking and intoxicated. People are likely to feel intimidated walking past such an establishment and young families and the elderly will avoid the area. There are already a lot of drinkers in the area (it is common to see people standing or walking in the street with bottles/cans in brown paper bags, obviously at some stage of inebriation) and encouraging this behaviour is a step backwards, compromising public safety.

The Protection of Children from Harm

The area is slowly becoming more 'child-friendly' and the nearby mosque attracts a lot of children at various times during the week. Introducing a club selling alcohol and playing loud music does not create a good environment for children to live and play.

I, Louise Ingledow, hereby declare that all information I have submitted is true and correct.

Signed: [REDACTED]

Date: 27/11/2015

Representation on licence application for:

The Village
118A West Green Road
London
N15 5AA

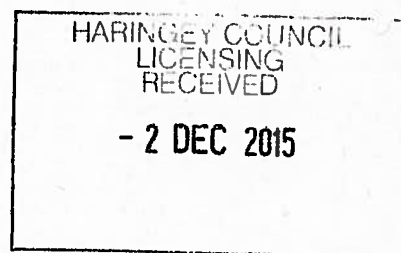

Name of licensee: Medina Basirika

The prevention of crime and disorder/public nuisance

The West Green Road has been a 'sensitive' area for many years and the Council's efforts since the riots (more cameras, upgrading shop fronts, communal garden, etc) have had a positive impact on the local community here. However, there are still regular occurrences of violence and abusive behaviour, and gatherings on the street, particularly at night/early hours of the morning.

As an example, When the Fountain pub (1.30-2.00am on Fridays/Saturdays) closes, a stream of people can be heard shouting, singing and sometimes fighting, cars revving their engines hard, racing, urinating and vomiting. If an additional premises were opened nearby, it would simply act as a focal point for all these people to go to, creating a new centre for determined drinkers from all over the locality.

This part of West Green Road has residential accommodation and also above shops/takeaways. Nearly all the shops operate between normal hours. A club operating all day to 4am would generate disturbing and intrusive levels of noise from music, talking/shouting, people traffic (coming and going), noise of cars parking/leaving all night/morning.

The area is improving slowly, the new flats at Lawrence Square (25 metres away) will bring 1800 new residents and their families from December, this is the kind of neighbourhood I want to live in, not one dominated by a club offering loud music and alcohol until 4 in the morning. It would be a big step backwards and undo the Council's good work here.

Public safety

During the day and night, the presence of customers standing on the street, smoking and intoxicated will cause people to avoid the vicinity, especially mothers with children and the elderly. There are a lot of obviously heavy drinkers in the area and encouraging these people is again a complete step backwards and compromises public safety. The increase in traffic will also put safety at risk in an already busy area.

Protection of children from harm

The area is becoming a better place for children to grow up in, the idea of having a club selling alcohol, purveying loud/club music and resultant anti-social behaviour on their doorstep, next to their homes, where they walk to and from school, does not create a good and safe environment for children.

I,  hereby declare that all information I have submitted is true and correct.

Signed: 

Date: 30/11/15

Representation on licence application for:

The Village
118A West Green Road
London
N15 5AA

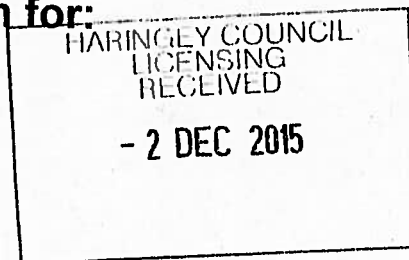

Name of licensee: Medina Basirika

The prevention of crime and disorder/public nuisance

The West Green Road has been a 'sensitive' area for many years and the Council's efforts since the riots (more cameras, upgrading shop fronts, communal garden, etc) have had a positive impact on the local community here. However, there are still regular occurrences of violence and abusive behaviour, and gatherings on the street, particularly at night/early hours of the morning.

As an example, When the Fountain pub (1.30-2.00am on Fridays/Saturdays) closes, a stream of people can be heard shouting, singing and sometimes fighting, cars revving their engines hard, racing, urinating and vomiting. If an additional premises were opened nearby, it would simply act as a focal point for all these people to go to, creating a new centre for determined drinkers from all over the locality.

This part of West Green Road has residential accommodation and also above shops/takeaways. Nearly all the shops operate between normal hours. A club operating all day to 4am would generate disturbing and intrusive levels of noise from music, talking/shouting, people traffic (coming and going), noise of cars parking/leaving all night/morning.

The area is improving slowly, the new flats at Lawrence Square (25 metres away) will bring 1800 new residents and their families from December, this is the kind of neighbourhood I want to live in, not one dominated by a club offering loud music and alcohol until 4 in the morning. It would be a big step backwards and undo the Council's good work here.

Public safety

During the day and night, the presence of customers standing on the street, smoking and intoxicated will cause people to avoid the vicinity, especially mothers with children and the elderly. There are a lot of obviously heavy drinkers in the area and encouraging these people is again a complete step backwards and compromises public safety. The increase in traffic will also put safety at risk in an already busy area.

Protection of children from harm

The area is becoming a better place for children to grow up in, the idea of having a club selling alcohol, purveying loud/club music and resultant anti-social behaviour on their doorstep, next to their homes, where they walk to and from school, does not create a good and safe environment for children.

I,  hereby declare that all information I have submitted is true and correct.

Signed: 

Date: 29-11-2015



Representation on licence application for:

The Village
118A West Green Road
London
N15 5AA

Name of licensee: Medina Basirika

The prevention of crime and disorder/ public nuisance

Local politicians have been working hard over the last number of years to create a welcoming community. However, there are still occurrences of violence and abusive behaviour, particularly at night/ early hours of the morning. There are often remnants on the road and pavement of car windows having been smashed in. As a result, local residents are reluctant to park their vehicles where there is footfall from late night premises. Having another late night operation in the area will only intensify this. Also, as the proposed new premises is open 2 hours longer than the local Fountain pub, it will create a new centre for determined drinkers from all over the locality.

The lane that runs behind the proposed beer garden for the establishment leads to Lawrence Yard a quiet residential pocket in North London, which is unique difficult to find. Unfortunately, because of it's secluded nature it is often used as a urinal, a place to gather for drinking and consuming other substances, as well as other nocturnal activity. The remains of these activities can be seen when you step out in the morning. Should planning for The Village go ahead, these activities will intensify, as those needing privacy will make use of the lane. This will cause a huge disruption to the residents of Lawrence Yard as bedrooms and living spaces face onto the lane.

With the new development in Lawrence Square attracting new people and families to the area, I don't think loud music and alcohol will endear them to the area.

Public safety

During the day and night, the presence of customers standing on the street, smoking and intoxicated will cause people to avoid the vicinity, especially mothers with children and the elderly. There are a lot of obviously heavy drinkers in the area and encouraging these people is again a step backwards and compromises public safety. The increase of traffic will also put safety at risk in an already busy area.

Protection of children from harm

Children from the local Masjid play on the lane where the proposed patio/garden will lead. With the remains of the night before visible on the lane, it will not be a safe or pleasant environment for children.

I, , hereby declare that all information I have submitted is true and correct.



6.12.15



Representation on licence application for:

The Village
118A West Green Road
London
N15 5AA

Name of licensee: Medina Basirika

The prevention of crime and disorder/ public nuisance

Local politicians have been working hard over the last number of years to create a welcoming community. However, there are still occurrences of violence and abusive behaviour, particularly at night/ early hours of the morning. There are often remnants on the road and pavement of car windows having been smashed in. As a result, local residents are reluctant to park their vehicles where there is footfall from late night premises. Having another late night operation in the area will only intensify this. Also, as the proposed new premises is open 2 hours longer than the local Fountain pub, it will create a new centre for determined drinkers from all over the locality.

The lane that runs behind the proposed beer garden for the establishment leads to Lawrence Yard a quiet residential pocket in North London, which is unique difficult to find. Unfortunately, because of it's secluded nature it is often used as a urinal, a place to gather for drinking and consuming other substances, as well as other nocturnal activity. The remains of these activities can be seen when you step out in the morning. Should planning for The Village go ahead, these activities will intensify, as those needing privacy will make use of the lane. This will cause a huge disruption to the residents of Lawrence Yard as bedrooms and living spaces face onto the lane.

With the new development in Lawrence Square attracting new people and families to the area, I don't think loud music and alcohol will endear them to the area.

Public safety

During the day and night, the presence of customers standing on the street, smoking and intoxicated will cause people to avoid the vicinity, especially mothers with children and the elderly. There are a lot of obviously heavy drinkers in the area and encouraging these people is again a step backwards and compromises public safety. The increase of traffic will also put safety at risk in an already busy area.

Protection of children from harm

Children from the local Masjid play on the lane where the proposed patio/garden will lead. With the remains of the night before visible on the lane, it will not be a safe or pleasant environment for children.

I, , hereby declare that all information I have submitted is true and correct.



6.12.15